

## INDEX

---

Instructions to make recycling stations ..... pag. 2

Wall mounting kit installation instructions ..... pag. 3



## Alicante recycling bin

### Internal Recycling Bins

### Instructions to make recycling stations



2 x Joint Plastic Rivets (each bin)

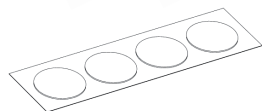

4 x Trim stickers for lateral holes (each bin)

1

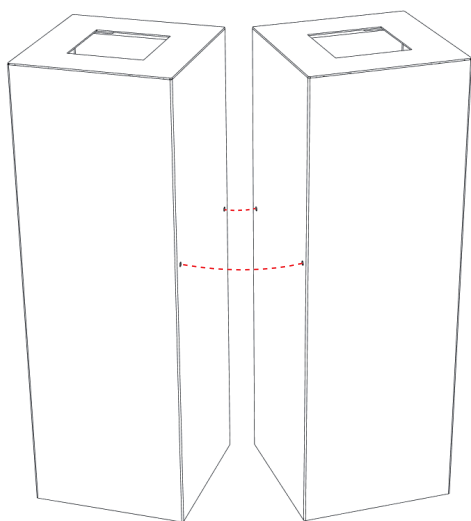

2

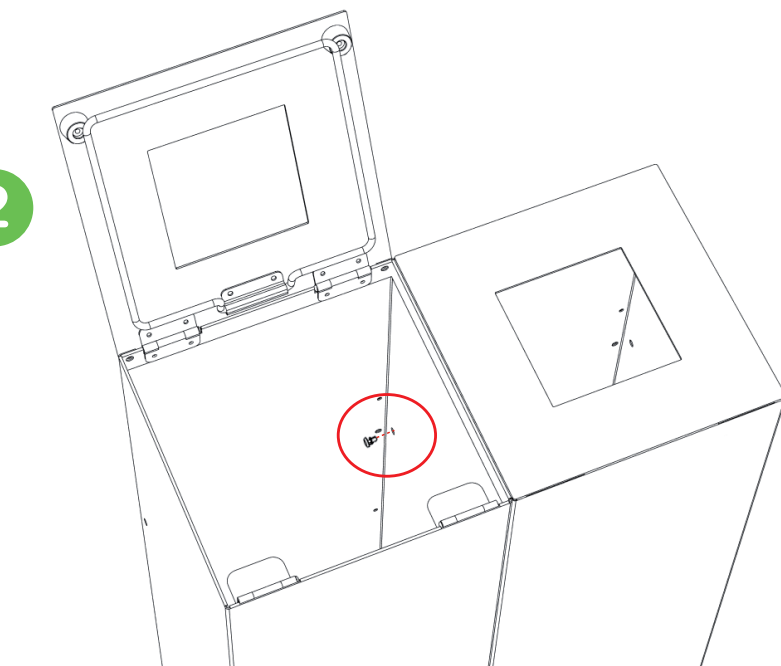

3

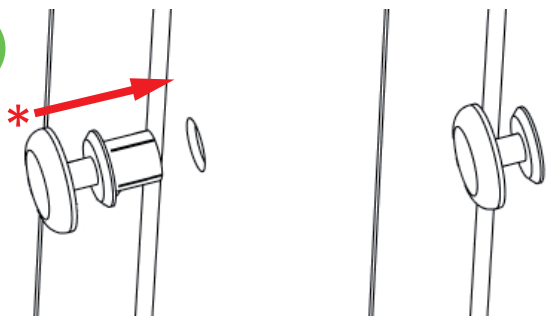

\* Warning!! is very important that the snap rivet must be inserted through holes in the two bins in this step

4

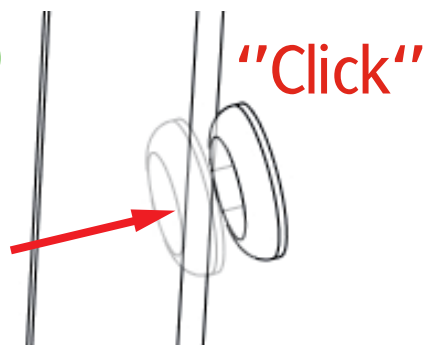

5

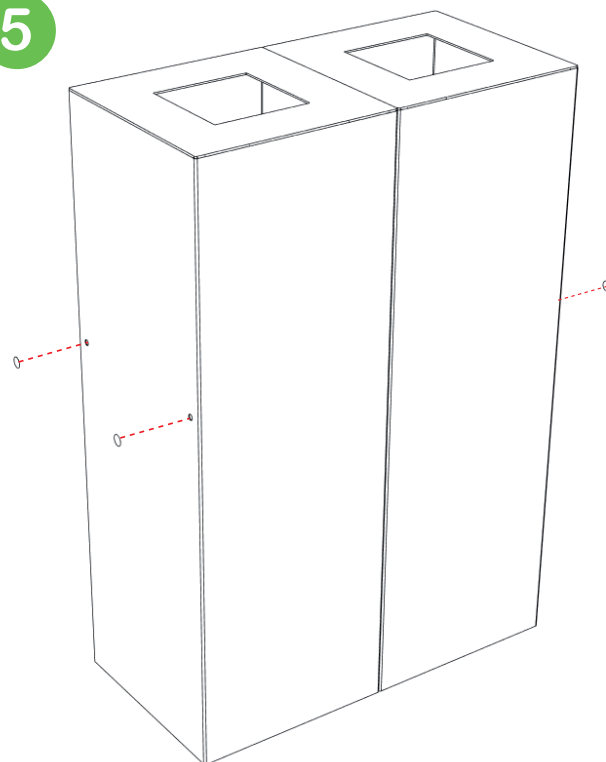

Place in the remaining side holes the adhesive covers



Phone. (+34) 96 555 02 67

Fax. (+34) 96 555 37 62

Avda. del juguete, 14

03440 IBI (Alicante) Spain

sales@cervic.com

www.cervicenvironment.com

- 1** Join the Wall mounted kit to the wall through the indicated holes below

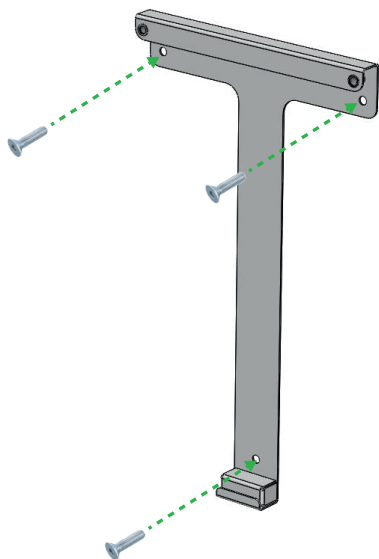

- 2** Insert the bottom of the bin in the groove kit

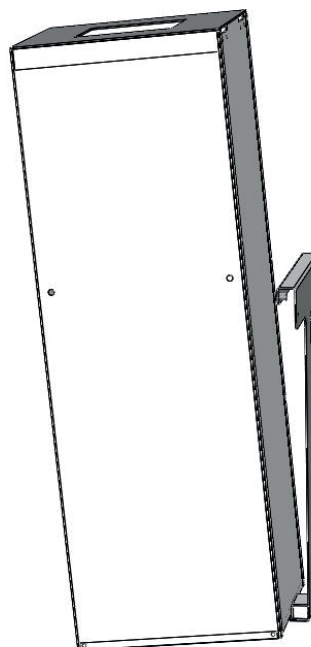

- 3** Finally, hold the bin to the kit and screw the bolts from inside the bin through the indicated holes

